



Classified

<i>Title</i>		<i>Doc. No.</i>	<i>Rev</i>	<i>Sheet</i>
iBA Air Filter Installation and Maintenance Procedure		WI124604	A	1(3)
<i>Reviewed</i>	<i>Author</i>	<i>Approved</i>	<i>Date</i>	
Christine.Blair	MATTHEW.DEZEN;Christine.Blair	HB	2023-01-16	

# iBA AIR FILTER KIT

## INSTALLATION & MAINTENANCE GUIDE

Title		Doc. No.	Rev	Sheet
iBA Air Filter Installation and Maintenance Procedure		WI124604	A	2(3)
Reviewed	Author	Approved	Date	
Christine.Blair	MATTHEW.DEZEN;Christine.Blair	HB	2023-01-16	

This document provides information on installing the iBA Air Filter Kit to the iBA Series Bench PIM Analyser. This guide has been prepared for use by technicians responsible for the daily operation and maintenance of the iBA Bench PIM Analyser.

## PRODUCT DESCRIPTION

The iBA Air Filter Kit main features are as follows:

1. Screw, 8Gx25, Matt Black, Button Head
2. iBA Dust Filter Bracket, Top Panel
3. iBA Dust Filter Bracket, Front Panel Top
4. iBA Dust Filter Bracket, Front Panel Bottom
5. iBA Dust Filter Foam, Top Panel
6. iBA Dust Filter Foam, Front Panel Top
7. iBA Dust Filter Foam, Front Panel Bottom

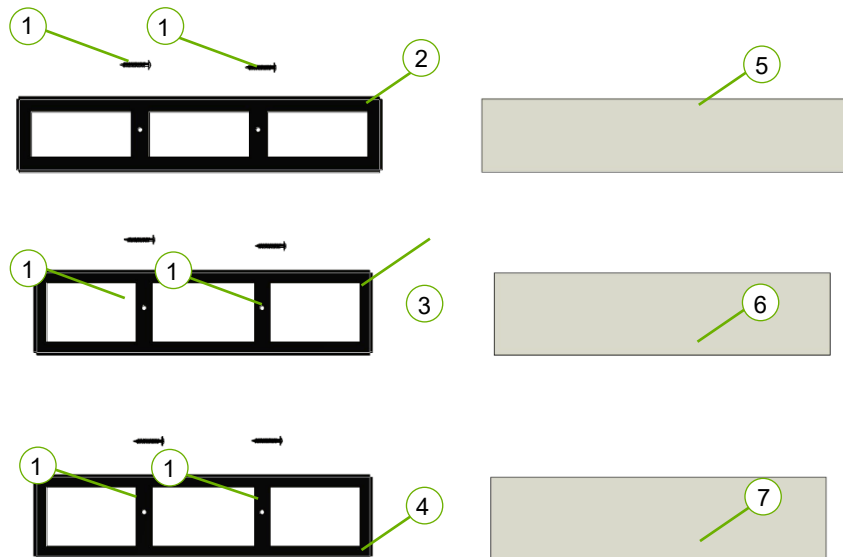

## INSTALLING THE AIR FILTER KIT

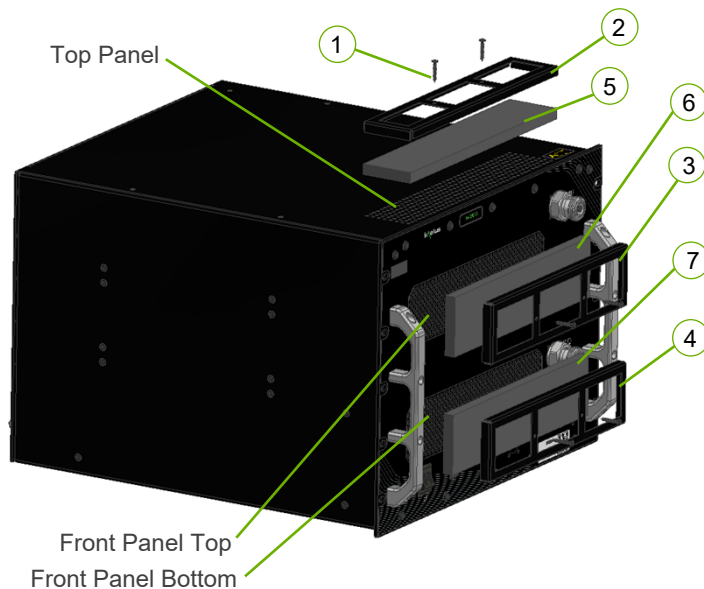

### Tools required

- 0.3Nm torque driver with PH2 Phillips screwdriver bit

### Installation instructions

**Step 1:** Prepare the air filter kits by placing the air filter foam behind the brackets.

**Step 2:** Place the air filter brackets on to the centre of the air inlet sections on the iBA front and top panels (B, C and D series only). Fasten using supplied button head screws, two per filter bracket. Tighten screws to 0.3Nm.

**Warning:** Tighten fixing screws to 0.3Nm maximum to avoid damaging air filter brackets



Title		Doc. No.	Rev	Sheet
iBA Air Filter Installation and Maintenance Procedure		W1124604	A	3(3)
Reviewed	Author	Approved	Date	
Christine.Blair	MATTHEW.DEZEN;Christine.Blair	HB	2023-01-16	

## SUMMARY OF PART NUMBERS

Item	Description	iBA A Series	iBA B&C Series	iBA D Series
1	Screw, 8Gx25, Matt Black, Button Head	CA124584, qty 4	CA124584, qty 6	CA124584, qty 6
2	iBA Dust Filter Bracket, Top Panel	R29-2091	R29-2091	R29-2091
3	iBA Dust Filter Bracket, Front Panel Top	R29-2090	R29-2089	R29-2090
4	iBA Dust Filter Bracket, Front Panel Bottom	N/A	R29-2090	R29-2090
5	iBA Dust Filter Foam, Top Panel	R29-2094	R29-2094	R29-2094
6	iBA Dust Filter Foam, Front Panel Top	R29-2092	R29-2093	R29-2092
7	iBA Dust Filter Foam, Front Panel Bottom	N/A	R29-2092	R29-2092

## MAINTENANCE: CLEANING THE AIR FILTER

Periodic cleaning of the air filter foam is recommended to ensure sufficient airflow through the unit, maximising performance and life of the iBA Series Bench PIM Analyser. The air filter foam material is designed to be cleaned using water, negating the need for replacement filters. The below procedure outlines the filter maintenance procedure.

**Step 1:** Remove the fastening screws securing the filter brackets. Remove the filter foams from the brackets. Clean by rinsing under cold running water until visual contamination has been removed. Allow to air dry. **Do not blast with compressed air as this may damage the filter foam material.**

**Step 2:** Once the filter foam is dry, reassemble and install the filter foams and filter brackets to their respective locations on the iBA units. Torque fastening screws per installation procedure.